

### TIMBER DOOR KEEPS

#### Latch Bolt Keeps

##### P1601 Standard Latch Keep

- 200 series latch keep
- Supplied as standard with the 296 and 297 panic latches

Construction - mild steel  
Finish - electro galvanised  
plated finish not available

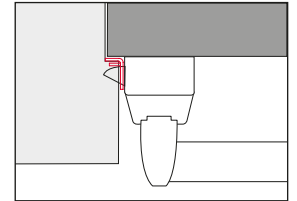
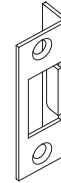

P1601

##### ED150 Latch Keep

- 200 series latch keep for timber and steel frames.
- Surface mounted.
- No clearance hole to accept latch is required

Construction - diecast zinc  
Finish - powder coated / RAL finish available on request  
plated finish not available

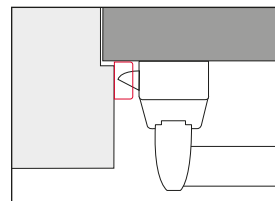
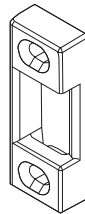

ED150 - Single Door

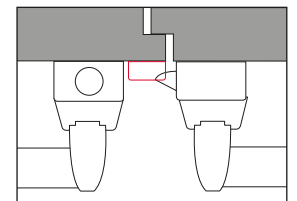

ED150 - Double Door

##### 300 Double Rebated Door Keep

- Used for rebated double doors for the Exidor 296 Push bar panic latch and 297 push pad panic latch.

Construction - mild steel  
Finish - powder coated / RAL finish available on request  
plated finish available

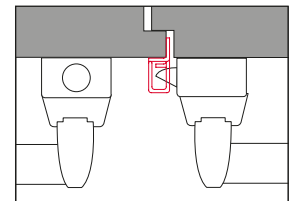
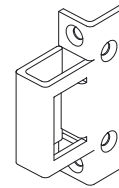

300

#### Top Bolt Keeps

##### P0401 Top Trip

- Used for standard bolts on timber frames.
- Supplied as standard with the 294 and 293 panic bolts

Construction - mild steel  
Finish - electro galvanised / RAL finish available on request  
plated finish not available

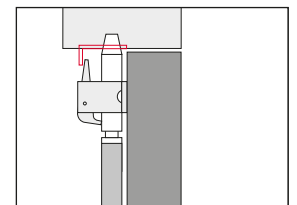
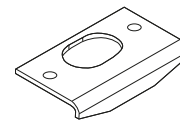

P0401

##### 2405 Top Trip

- Surface mounted keep for top shoot bolts on timber and steel frames
- For flush fitting doors / frames
- Used with 200 series panic bolts

Construction - mild steel  
Finish - electro galvanised / RAL finish available on request  
plated finish not available

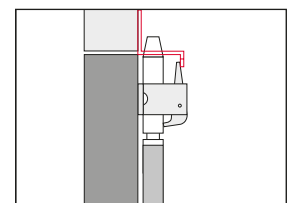
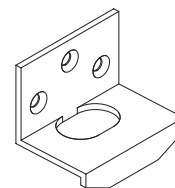

2405

### 3405A Top Trip

- Surface mounted keep for timber top header rail
- No clearance hole in the header rail to accept the top shoot bolt is required

Construction - diecast zinc / mild steel  
Finish - electro galvanised  
plated finish not available

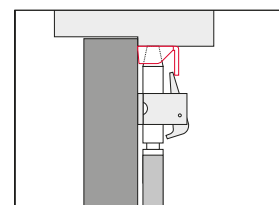
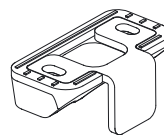

3405A

### 2401 Top Trip

- Surface mounted keep for top shoot bolts
- Kit supplied includes spacers for applications where the distance between the header rail and the door face is between 14mm and 21mm

Construction - mild steel  
Finish - electro galvanised / RAL finish available on request  
plated finish not available

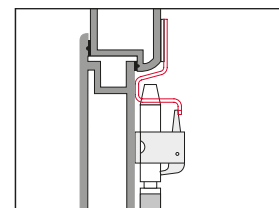
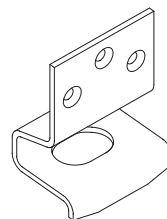

2401

## Bottom Bolt Keeps

### 2403 Low Threshold Bottom Keep

- For low thresholds or an alternative to boring a hole in a concrete floor to accept the bottom shoot bolt
- Designed to the requirements of CEN standards and building regulations

Construction - mild steel  
Finish - electro galvanised / RAL finish available on request  
plated finish not available

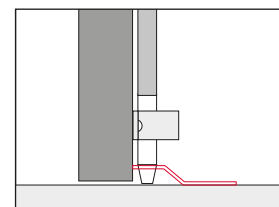
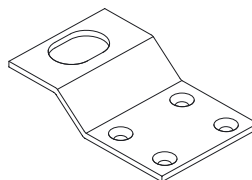

2403

### 3405 Bottom Keep

- Surface mounted keep for bottom shoot bolts
- No clearance hole in the floor is required

Construction - diecast zinc  
Finish - electro galvanised  
plated finish not available

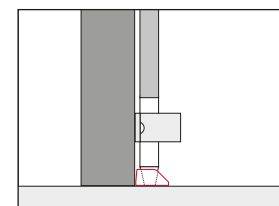
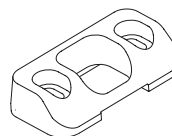

3405

## Pullman Latch Keeps

### 3401 Vertical Pullman Latch Keep

- For 300 series vertical Pullman latches on flush fitting doors / frames

Construction - mild steel  
Finish - electro galvanised / RAL finish available on request  
plated finish not available

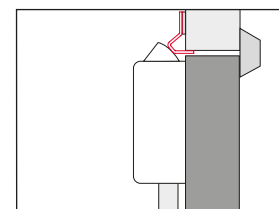
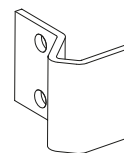

3401

### 3402 Vertical Pullman Latch Keep

- For 300 series vertical Pullman latches
- Supplied as standard with all Pullman latch units

Construction - diecast aluminium  
Finish - powder coated black  
plated finish not available

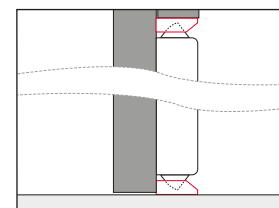
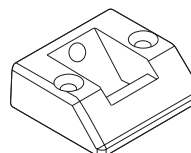

3402

### 407 Horizontal Pullman Latch Keep

- Used with Exidor horizontal Pullman latches for both flush fitting doors/frames and on double rebated door applications
- Supplied as standard with the 307 and 308 panic bolt

Construction - mild steel  
Finish - electro galvanised / RAL finish available on request  
plated finish available

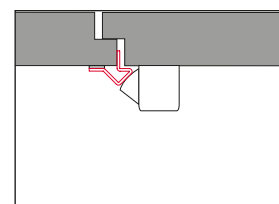
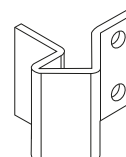

407

# STEEL DOOR KEEPS

## Latch Bolt Keeps

### ED150 Latch Keep

- 200 series latch keep for timber and steel frames
- Surface mounted
- No clearance hole to accept latch is required

Construction - diecast zinc

Finish - electro galvanised / RAL finish available on request  
plated finish not available

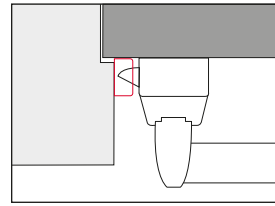
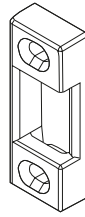

ED150 - Single Door

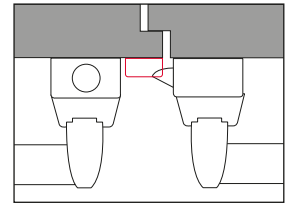

ED150 - Double Door

### 3404 Latch Keep

- 200 series latch keep for steel frames

Construction - mild steel

Finish - electro galvanised  
plated finish not available

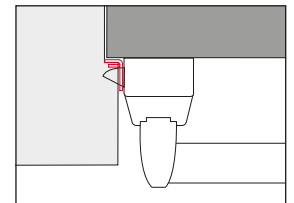
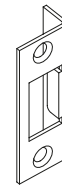

3404

### 300 Double Rebated Door Keep

- Used for rebated double doors for the Exidor 296 push bar panic latch and 297 push pad panic latch

Construction - mild steel

Finish - electro galvanised / RAL finish available on request  
plated finish available

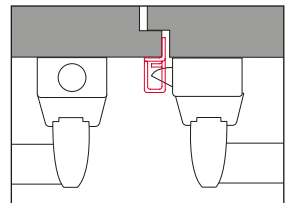
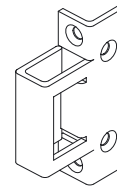

300

## Top Bolt Keeps

### 2405 Top Trip

- Surface mounted keep for top shoot bolt on timber and steel frames
- For flush fitting doors / frames
- Used with 200 series panic bolts

Construction - mild steel

Finish - electro galvanised / RAL finish available on request  
plated finish not available

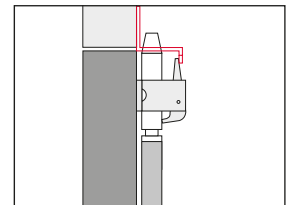
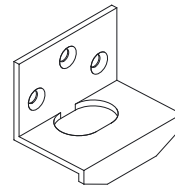

2405

### 3405A/SD Keep

- Surface mounted keeps for steel top header rail
- No clearance hole in the header rail to accept the top shoot bolt is required

Construction - diecast zinc / mild steel

Finish - electro galvanised  
plated finish not available

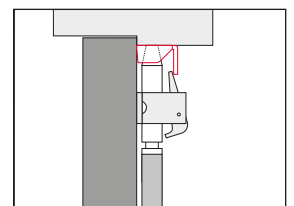
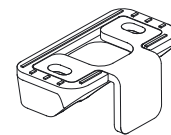

3405A/SD

## Bottom Bolt Keeps

### 2403 Low Threshold Bottom Keep

- For low thresholds or an alternative to boring a hole in a concrete floor to accept the bottom shoot bolt
- Design to the requirements of CEN standards and building regulations

Construction - mild steel

Finish - electro galvanised / RAL finish available on request  
plated finish not available

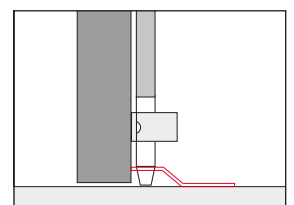
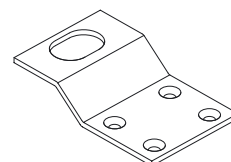

2403

### 3405 Bottom Keep

- Surface mounted keep for bottom shoot bolts
- No clearance hole in the floor is required

Construction - diecast zinc  
Finish - electro galvanised  
plated finish not available

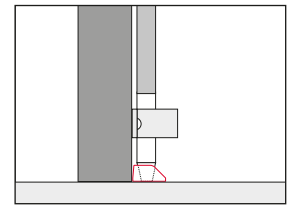
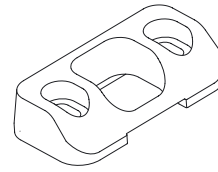

3405

## Pullman Latch Keeps

### 3401 Vertical Pullman Latch Keep

- For 300 series vertical Pullman latches on flush fitting doors / frames

Construction - mild steel  
Finish - electro galvanised / RAL finish available on request  
plated finish not available

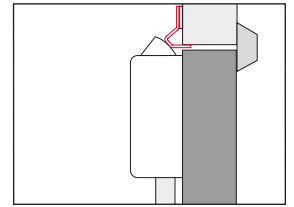
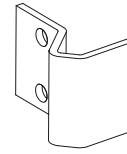

3401

### 3402 Vertical Pullman Latch Keep

- For 300 series vertical Pullman latches
- Supplied as standard with all Pullman latch units

Construction - diecast aluminium  
Finish - powder coated black  
plated finish not available

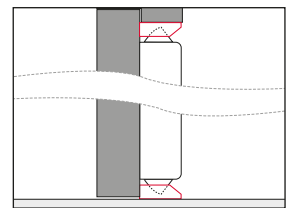
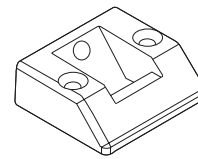

3402

### 407 Horizontal Pullman Latch Keep

- Used with Exidor horizontal Pullman latches for both flush fitting doors/frames and on double rebated door applications
- Supplied as standard with the 307 and 308 panic bolts

Construction - mild steel  
Finish - electro galvanised / RAL finish available on request  
plated finish available

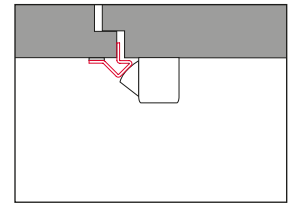
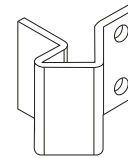

407

## UPVC DOOR KEEPS

### Top Bolt Keeps

### 2401 Top Trip

- Surface mounted keep for top shoot bolts
- Kit supplied includes spacers for applications where the distance between the header rail and the door face is between 14mm and 21mm

Construction - mild steel  
Finish - electro galvanised / RAL finish available on request  
plated finish not available

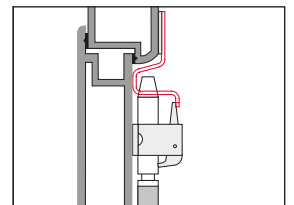
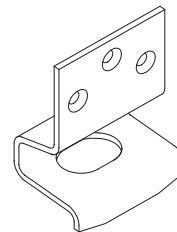

2401

### Bottom Bolt Keeps

### 2403 Low Threshold Bottom Keep

- For low thresholds or an alternative to boring a hole in a concrete floor to accept the bottom shoot bolt
- Design to the requirements of CEN standards and building regulations

Construction - mild steel  
Finish - electro galvanised / RAL finish available on request  
plated finish not available

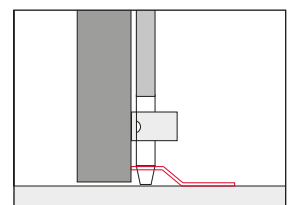
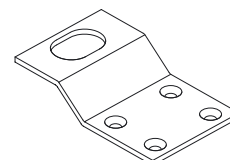

2403

### 3405 Bottom Keep

- Surface mounted keep for bottom shoot bolts
- No clearance hole in the floor is required

Construction - diecast zinc  
Finish - electro galvanised  
plated finish not available

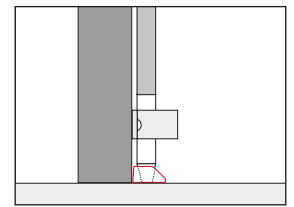
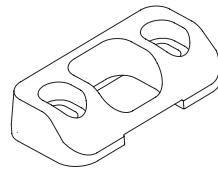

3405

### 2402 Bottom Keep

- For UPVC doors / frames that have a high threshold
- Complete with spacers for applications where the distance between the door face and face of the threshold is between 14mm and 21mm
- Ideal to use with 2401 top trip keep

Construction - mild steel  
Finish - electro galvanised / RAL finish available on request  
plated finish not available

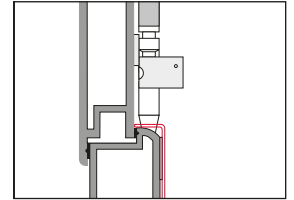
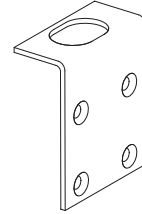

2402

## Pullman Latch Keeps

### 3401 Vertical Pullman Latch Keep

- For 300 series vertical Pullman latches on flush fitting doors / frames

Construction - mild steel  
Finish - electro galvanised / RAL finish available on request  
plated finish not available

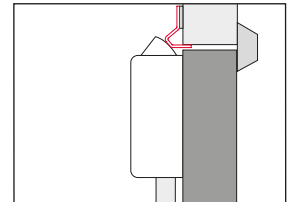
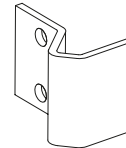

3401

### 3402 Vertical Pullman Latch Keep

- For 300 series vertical Pullman latches
- Supplied as standard with all Pullman latch units

Construction - diecast aluminium  
Finish - powder coated black  
plated finish not available

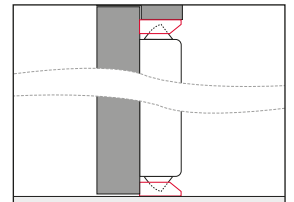
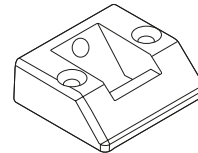

3402

### 407 Horizontal Pullman Latch Keep

- Used with Exidor horizontal Pullman latches for both flush fitting doors/frames and on double rebated door applications
- Supplied as standard with the 307 and 308 panic bolts

Construction - mild steel  
Finish - powder coated silver / RAL finish available on request  
plated finish available

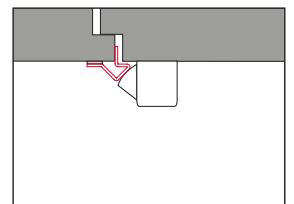
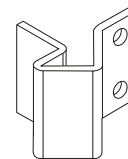

407

### 3403 Keep

- Used for 300 series horizontal latches on UPVC double doors
- Optional longer version available (SL-0156)

Construction - mild steel  
Finish - electro galvanised / RAL finish available on request  
plated finish not available

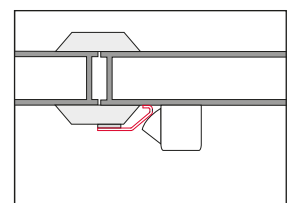
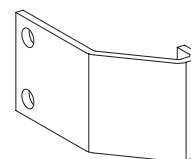

3403